



R2 ALUMINIUM

FOR THE ULTIMATE IN MICRO-LIVING, THIS FULLY INSULATED, ALUMINIUM CLAD ROOST CLEVERLY INCLUDES A MICRO-KITCHEN, SHOWER, LOO AND LIVING AREA WITH MORE THAN ENOUGH SPACE TO FIT A SOFA-BED.

PERFECT FOR AN OFFICE OR GUEST ACCOMMODATION THIS MULTI-FUNCTIONAL SPACE MEASURES IN AT A NEAT 2.8 X 4.5M. CEDAR CLADDING ALSO AVAILABLE.

Prices start from £18,900.00 (+VAT)

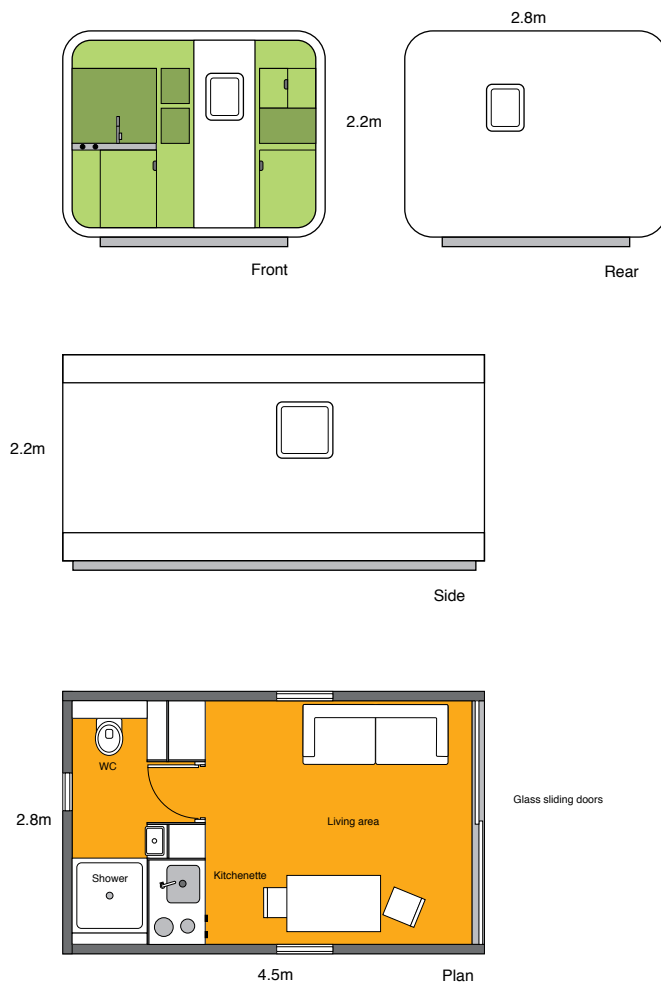

ROOF: Cold bond single ply membrane rubber with options for Sedum Grass "live" matting which greatly reduces visual impact from above.

STRUCTURE: SIPs (Structurally Insulated Panels) with high thermal efficiency reducing energy consumption significantly, good sound insulation and low U values.

GLAZING: Fixed double glazed unit.

DOORS: Sliding double glazed door and fixed panel in powder coated frame. Many frame colours to choose from.

INTERNAL WALL COVERING: Plywood Birch panels fixed and sealed with polyurethane.

EXTERNAL WALL COVERINGS: Resilient Western Red Cedar cladding with natural resistance to rot and insect damage left to silver as it ages.

FLOOR COVERING: Dalsouple rubber flooring with a choice of colour from an extensive range. Other floor coverings available (see extras).

FOUNDATIONS: Concrete pads in the ground on to which the structure will be supported.

ELECTRICAL: 4 x down lighters, 4 x double socket outlets, 1 slim panel heater with timer, 1 consumer unit with RCD. Connection to house or mains supply not included.

EXTRAS

- Kitchenette: £1,500.00
- W.C. and basin: £2,600.00
- Storage unit: £650.00
- Shower module: £1,900.00

OTHER EXTRAS AVAILABLE

- Wood flooring / carpet
- External Lighting
- Electrical under-floor heating
- External Decking area